

NOW LEASING

Market Park

Anchored by Safeway and CVS
100,692 SF Shopping Center
Berryessa Rd. & Sierra Rd., San Jose, CA

New Mixed-Use Transit Village
BART NOW OPEN!

NOW UNDER CONSTRUCTION
Scheduled Completion
First Quarter, 2021

BRUCE FRAZER

408.216.2315 | bruce.frazer@srsre.com

CA Lic. No. 00576968



Development &
Project Management

901 Campisi Way, Suite 245 | Campbell, CA 95008



Market Park
SAN JOSE



MARKET PARK

Berryessa Rd. & Sierra Rd., San Jose, CA

- **Entitled Mixed-Use Transit Village on 120 Acres**

- Approximately 1,000 new residential units adjacent to the shopping center.
- The south side of the project adjacent to BART is in the process of being entitled for approximately 3,400 residential units and up to 1,500,000 SF of office.

- **Easy Access to Mass Transit**

- BART extension to Downtown SJ now officially underway with Design and ROW acquisition. Scheduled to open for service in 2025 with connection to Diridon Train Station, Cal Train and High Speed Rail.
- One hour direct BART ride to Financial District in Downtown San Francisco.

- **Watch KPIX Video:** [CLICK HERE](#)

- **Watch Construction Progress:** [CLICK HERE](#)

- **Watch Groundbreaking Video:** [CLICK HERE](#)

- New VTA Bus Transit Center & Express Bus Service to Downtown San Jose.
- Direct access to Penitencia Creek Bike Trail and Coyote Creek Trail.

- **Outstanding Silicon Valley Location & Utility**

- Urban core of Silicon Valley, home to over 6,600 technology companies.
- Excellent access to major freeways (I-680, I-880, US Highway 101).
- Prime in-fill location surrounded by recreational, entertainment, educational and business attractions.

- **Impressive Demographics (5 Mile Radius)**

- 590,947 population (734,027 daytime: workers & residents)
- \$112,120 average household income

RETAIL DELIVERY - FIRST QUARTER, 2021 (EST.)

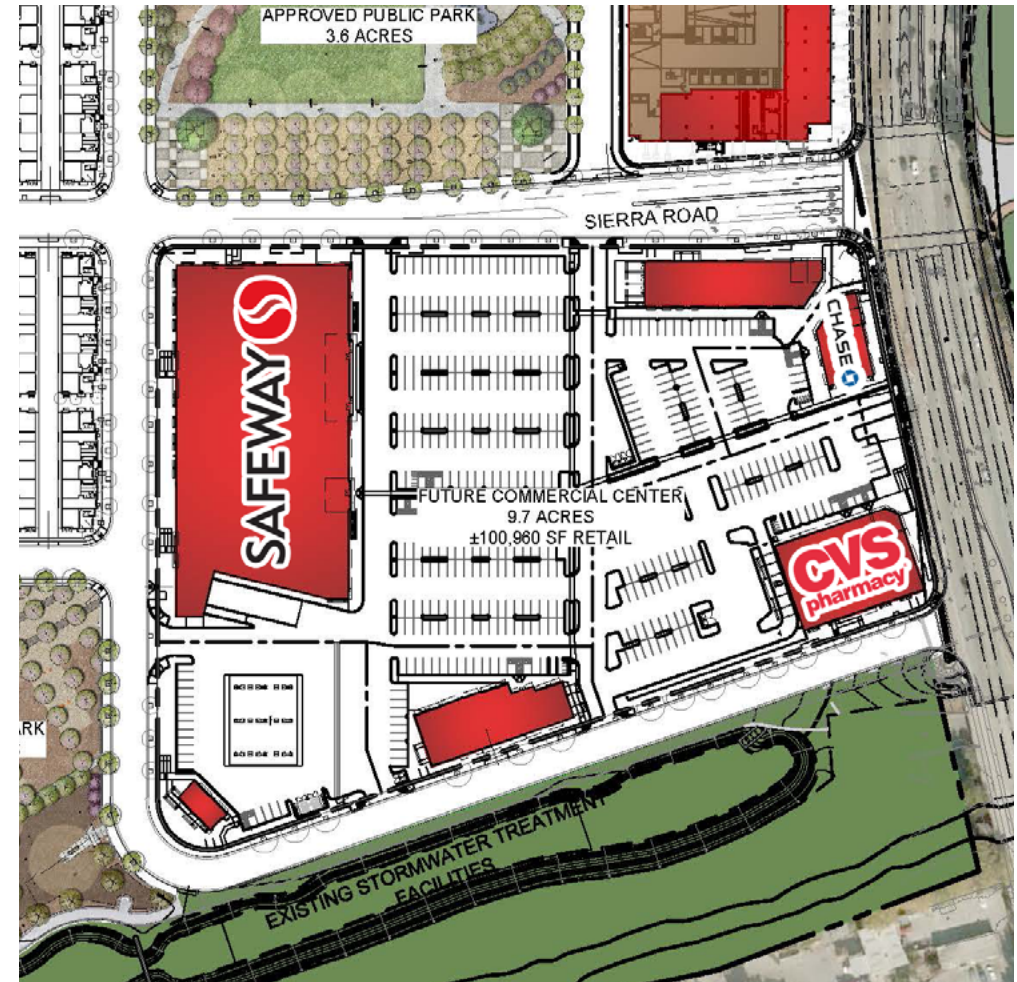

Exclusive Listing Agent:

BRUCE FRAZER

Senior Vice President

408.216.2315 | bruce.frazer@srsre.com

CA Lic: 00576968



**Development &
Project Management**

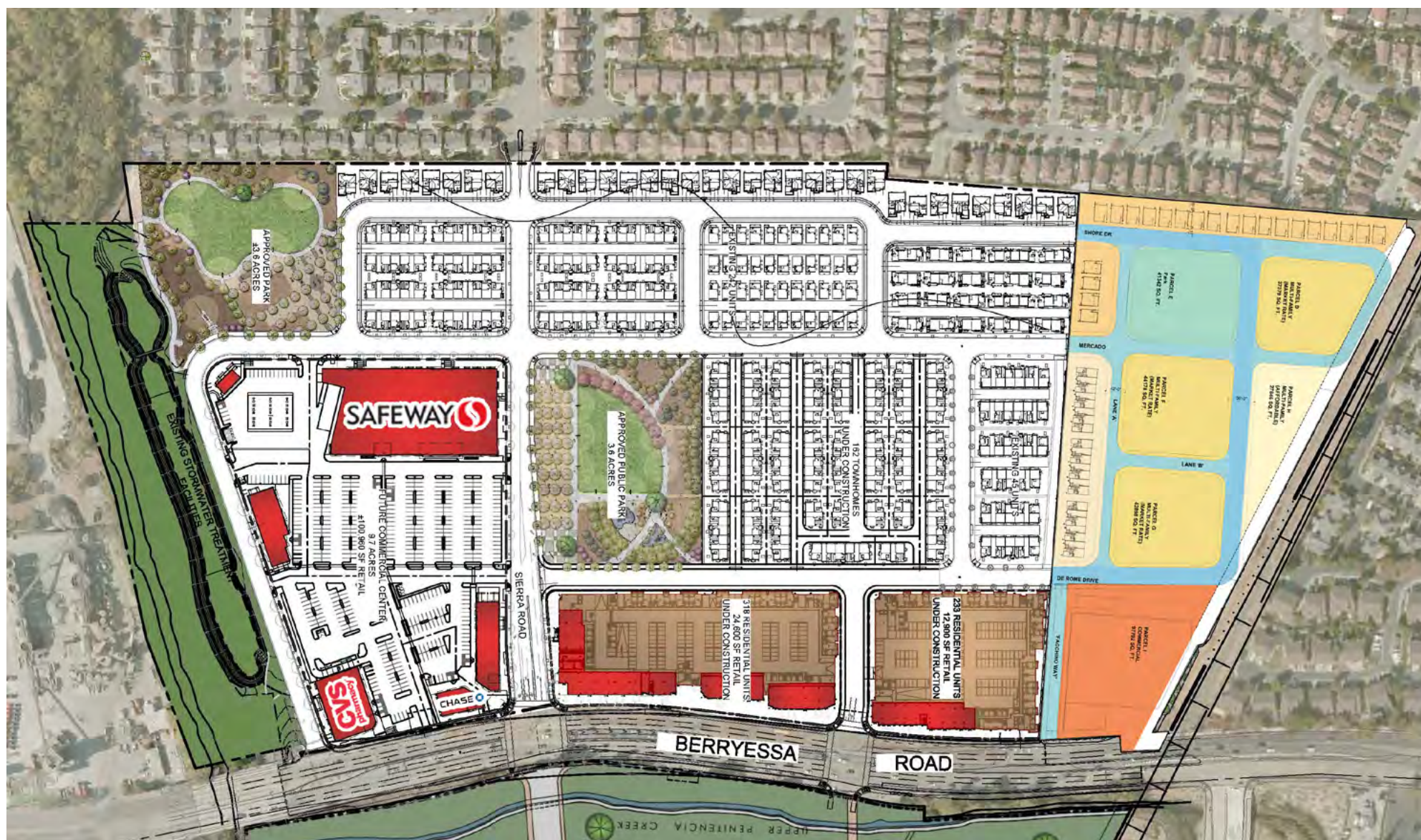

Exclusive Listing Agent:

BRUCE FRAZER

Senior Vice President

408.216.2315 | bruce.frazer@srsre.com

CA Lic: 00576968



Development &
Project Management



Exclusive Listing Agent:

BRUCE FRAZER

Senior Vice President

408.216.2315 | bruce.frazer@srsre.com

CA Lic: 00576968



Development &
Project Management



Exclusive Listing Agent:

BRUCE FRAZER

Senior Vice President

408.216.2315 | bruce.frazer@srsre.com

CA Lic: 00576968



Development &
Project Management



Exclusive Listing Agent:

BRUCE FRAZER

Senior Vice President

408.216.2315 | bruce.frazer@srsre.com

CA Lic: 00576968



Development &
Project Management



Exclusive Listing Agent:

BRUCE FRAZER

Senior Vice President

408.216.2315 | bruce.frazer@srsre.com

CA Lic: 00576968



Development &
Project Management



Exclusive Listing Agent:

BRUCE FRAZER

Senior Vice President

408.216.2315 | bruce.frazer@srsre.com

CA Lic: 00576968



Development &
Project Management

WESTERN NATIONAL GROUP

Phase 1 of above reference project

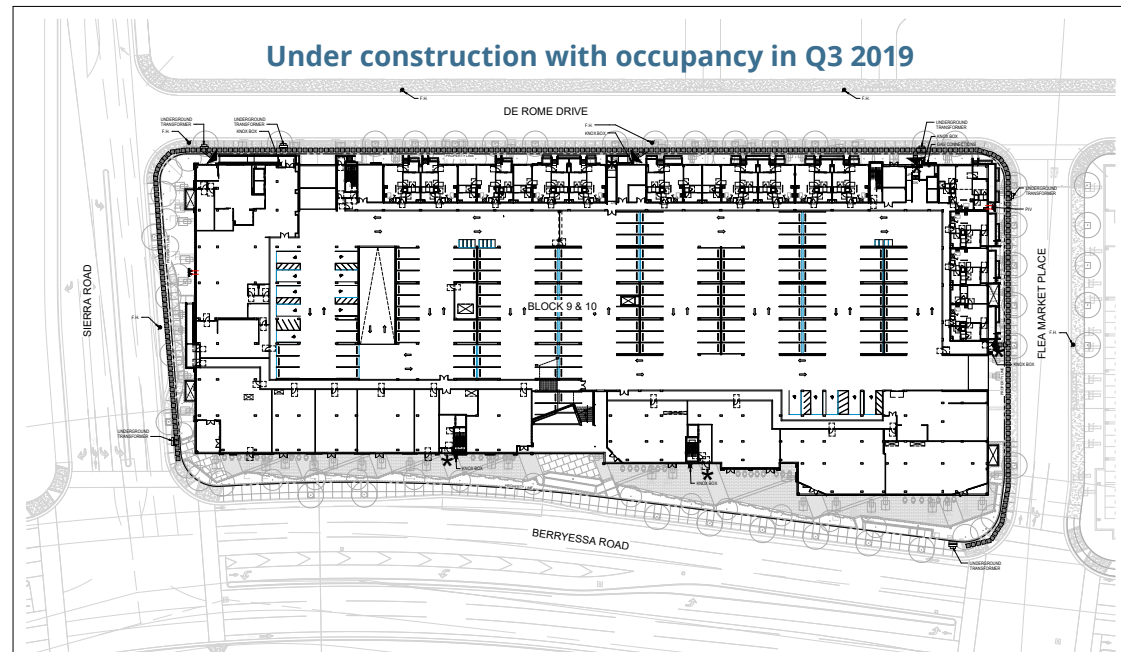

Exclusive Listing Agent:

BRUCE FRAZER

Senior Vice President

408.216.2315 | bruce.frazer@srsre.com

CA Lic: 00576968



Development &
Project Management



KB Home is finishing their final phase of 162 townhomes called Apex at Berryessa Crossing. KB Home previously built 287 single-family and townhomes. All phases total 449 units.

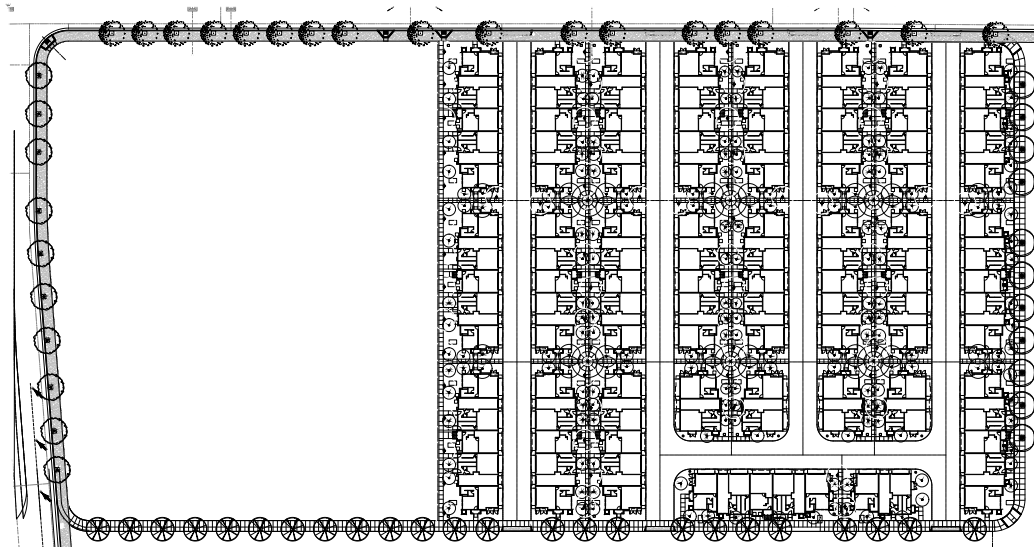

Exclusive Listing Agent:

BRUCE FRAZER

Senior Vice President

408.216.2315 | bruce.frazer@srsre.com

CA Lic: 00576968



Development &
Project Management

AREA SUMMARY - Town Home

	Parcel size (AC)	Parcel size by type (AC)	
Parcel A: Single Family	1.1	Single Family	1.4
Parcel B: Single Family	0.3		
Parcel C: Town Homes	0.8	Town Homes	0.8
Parcel D: Market Rate	0.9		
Parcel E: Public Open Sp	0.9		
Parcel F: Market Rate	1.0		
Parcel G: Market Rate	1.0	Market Rate	2.9
Parcel H: Affordable	0.6	Affordable	0.6
Parcel I: Commercial	2.2	Commercial	2.2
Circulation - Secondary	3.8	Circulation- Primary	
Bart Setback	0.7		
Total Parcel Size	13.0		8.0

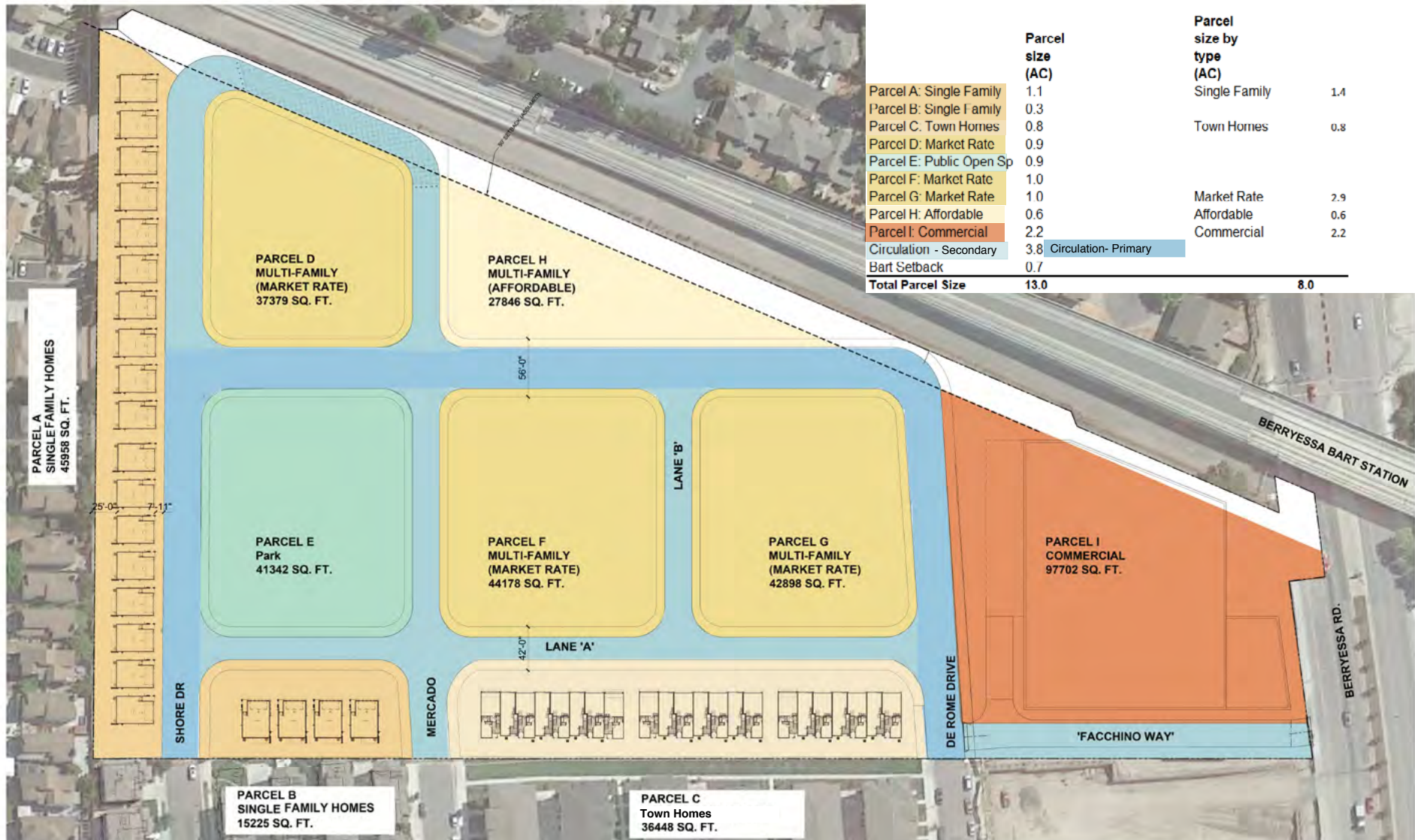

Exclusive Listing Agent:

BRUCE FRAZER

Senior Vice President

408.216.2315 | bruce.frazer@srsre.com

CA Lic: 00576968



Development & Project Management



MARKET PARK - SOUTH VILLAGE

BERRYESSA BART TRANSIT VILLAGE, SAN JOSE, CALIFORNIA

BERRYESSA PROPERTIES, LLC

KENNETH RODRIGUES & PARTNERS, INC.

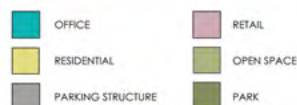

PROJECT:
DATE: 30.408
10.23.2019

MASTER SITE PLAN

A-1

Exclusive Listing Agent:

BRUCE FRAZER

Senior Vice President

408.216.2315 | bruce.frazer@srsre.com

CA Lic: 00576968



Development &
Project Management



Exclusive Listing Agent:

BRUCE FRAZER

Senior Vice President

408.216.2315 | bruce.frazer@srsre.com

CA Lic: 00576968



Development &
Project Management

South Ground Floor Retail Adjacent to BART



Exclusive Listing Agent:

BRUCE FRAZER

Senior Vice President

408.216.2315 | bruce.frazer@srsre.com

CA Lic: 00576968



Development &
Project Management



Exclusive Listing Agent:

BRUCE FRAZER

Senior Vice President

408.216.2315 | bruce.frazer@srsre.com

CA Lic: 00576968



Development &
Project Management

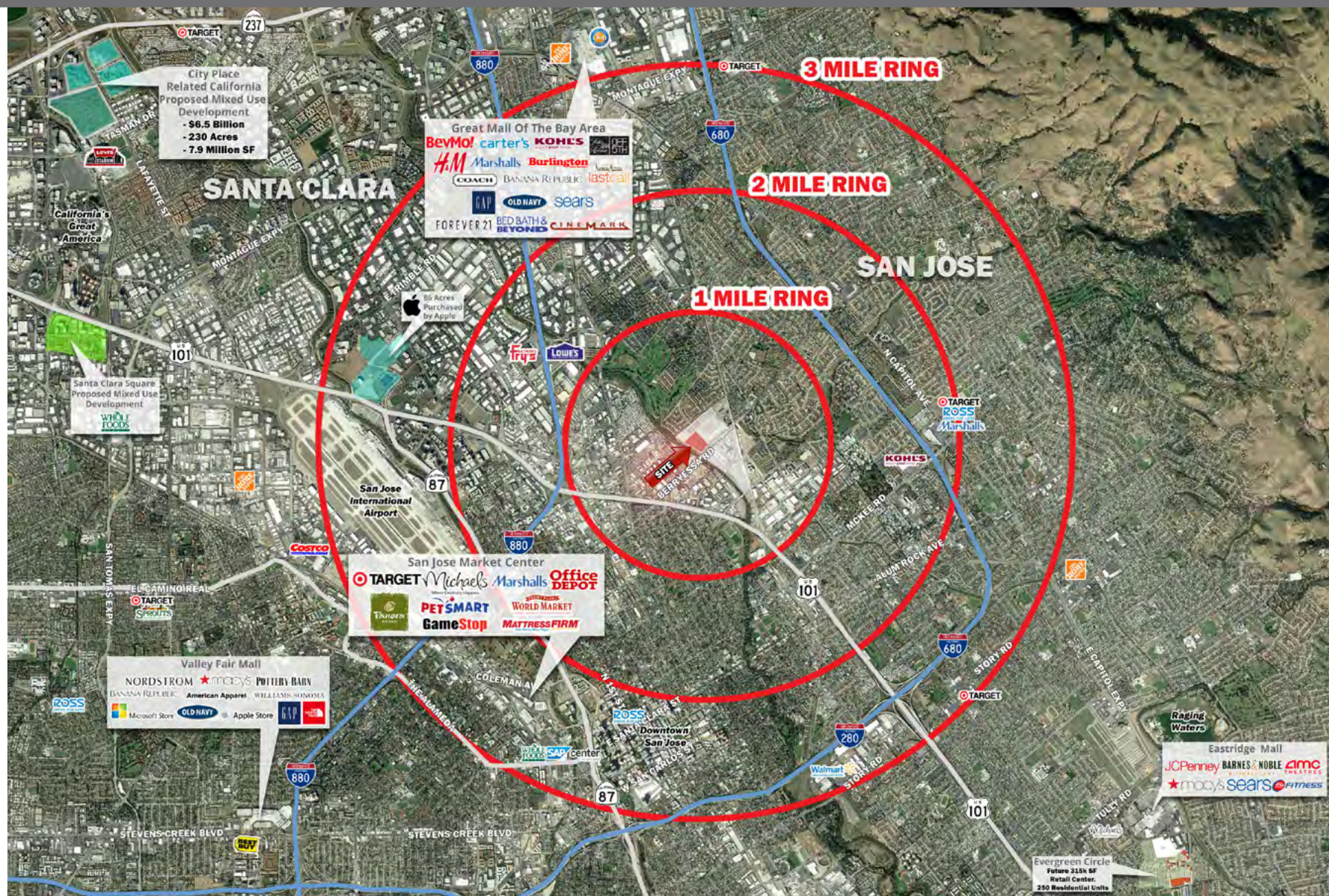

Exclusive Listing Agent:

BRUCE FRAZER

Senior Vice President

408.216.2315 | bruce.frazer@srsre.com

CA Lic: 00576968



Development &
Project Management

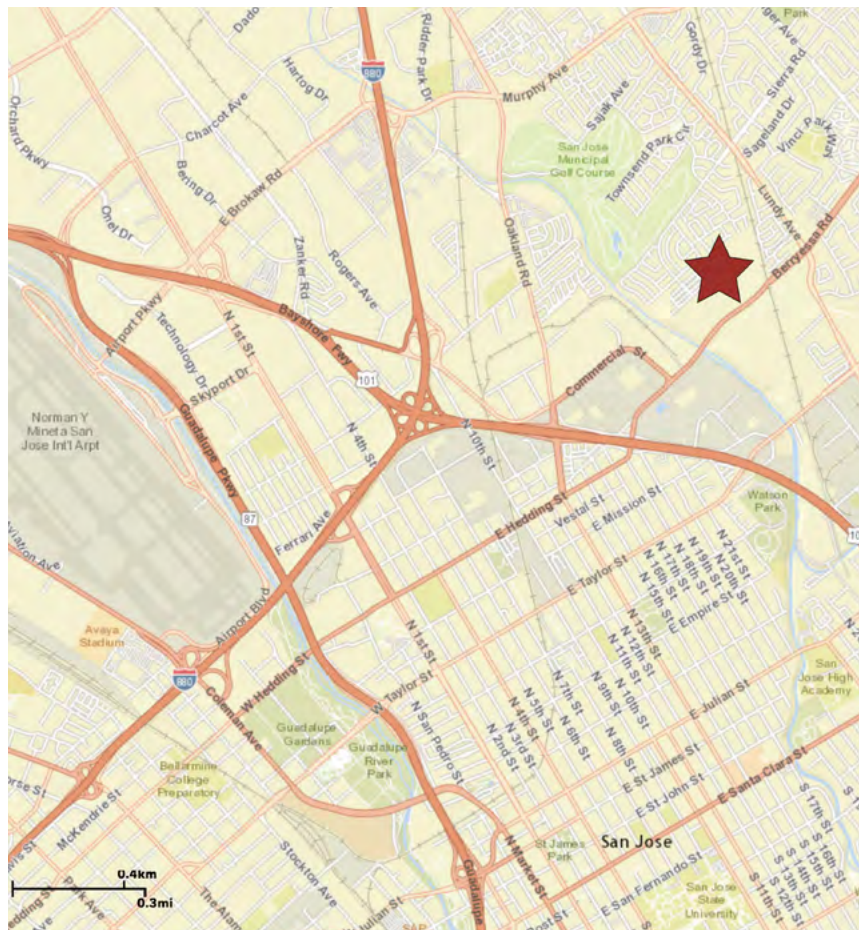

SAN JOSE FAST FACTS:

- ▶ 10th largest city in the U.S. and Silicon Valley's urban center
- ▶ Host to unprecedented skilled, international workforce
- ▶ Home to more than half the largest tech firms in the world
- ▶ Represents one-third of venture capital funding in the U.S.
- ▶ Leads the nation in patent generation
- ▶ Equidistant to San Francisco and the Monterey Peninsula



Exclusive Listing Agent:

BRUCE FRAZER

Senior Vice President

408.216.2315 | bruce.frazer@srsre.com

CA Lic: 00576968



Development &
Project Management

	1 Mile Radius	3 Mile Radius	5 Mile Radius
POPULATION			
2019 Population	25,059	248,887	589,719
2024 Projected Growth	28,036	264,675	624,087
Annual Growth: 2019-2024	2.27%	1.24%	1.14%
Median Age	37.3	34.7	34.8
HOUSEHOLDS			
2019 Households	7,248	75,421	181,136
2024 Estimated Households	8,040	80,555	192,278
Projected Household Growth: 2019-2024	2.10%	1.33%	1.20%
EDUCATION: Bachelor's / Graduate / Professional Degree	46.6%	37.9%	39.7%
INCOME: Average Household	\$134,160	\$116,316	\$126,496
DAYTIME POPULATION (In Area)			
2019 Daytime Population	12,099	182,896	391,065
Total Businesses	896	13,567	28,734
RACE			
White	18.8%	28.0%	32.1%
Hispanic	25.8%	36.1%	36.6%
Black	1.5%	3.0%	3.0%
Asian	61.9%	45.3%	40.7%

Source: Esri and InfoGroup, U.S. Census

Exclusive Listing Agent:

BRUCE FRAZER

Senior Vice President

408.216.2315 | bruce.frazer@srsre.com

CA Lic: 00576968



Development &
Project Management

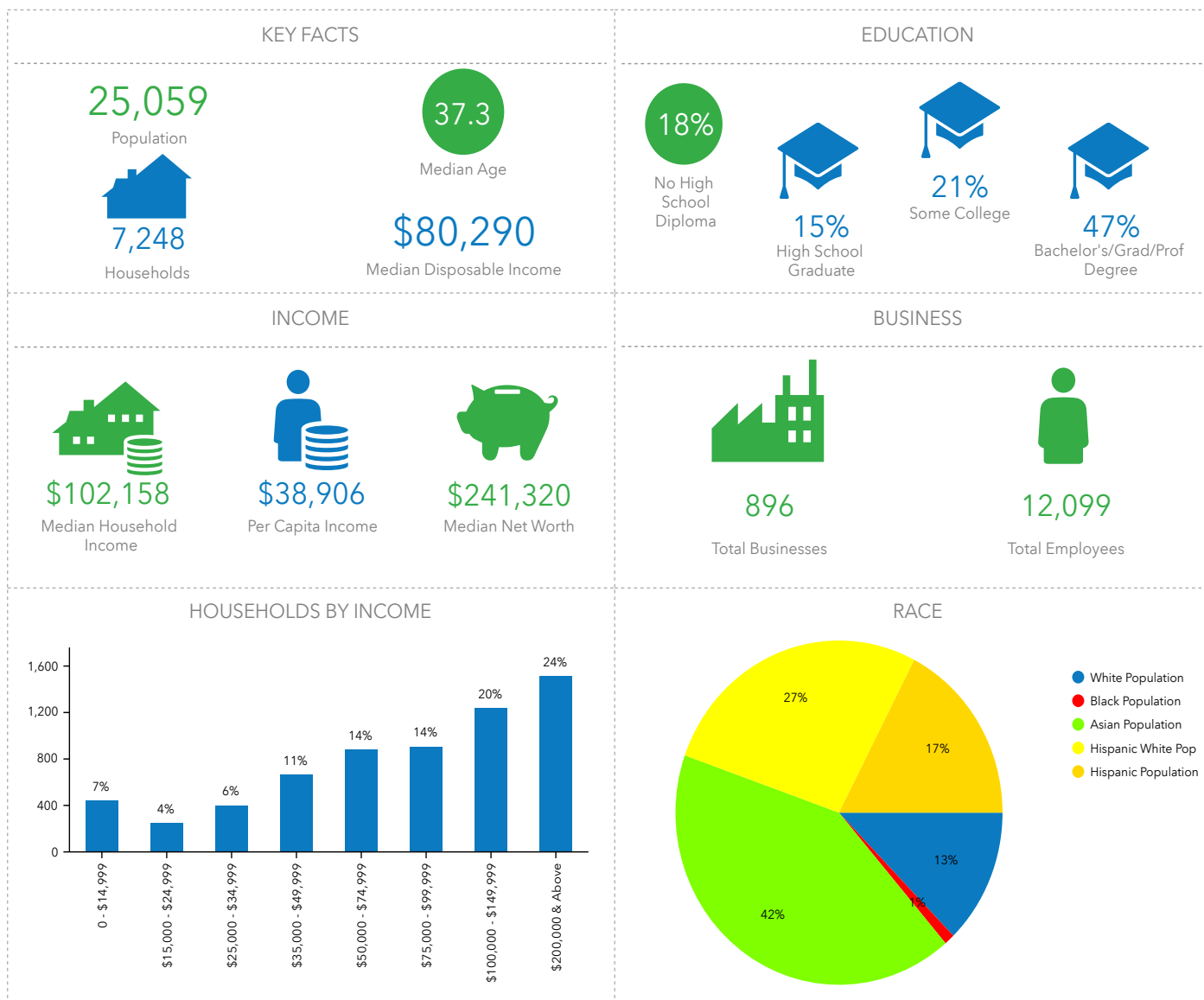

Exclusive Listing Agent:

BRUCE FRAZER

Senior Vice President

408.216.2315 | bruce.frazer@srsre.com

CA Lic: 00576968



Development &
Project Management



Exclusive Listing Agent:

BRUCE FRAZER

Senior Vice President

408.216.2315 | bruce.frazer@srsre.com

CA Lic: 00576968



Development &
Project Management

SRS Real Estate Partners | 901 Campisi Way, Suite 245 | Campbell, CA 95008 | 408.553.6135 | www.srsre.com/sfbayarea

The information contained herein was obtained from sources deemed to be reliable. However, SRS Real Estate Partners makes no guarantees, warranties, or representations as to the completeness or accuracy thereof.